

Date: 2023-06-26  
 Enquiry dated:  
 Project:  
 Quotation-no.:  
 Item:  
 Reference:

**Air cooler GGHF 045.2H/17-ANW50/24P.E For calculation only!**

<b>Capacity:</b>	9.8 kW <sup>(1)</sup>	<b>Medium:</b>	Ethylene glycol 34 Vol. % <sup>(2)</sup>
<b>Surface reserve:</b>	0.0 %	<b>Inlet:</b>	-5.0 °C
<b>Air flow:</b>	5140 m <sup>3</sup> /h	<b>Outlet:</b>	0.0 °C
<b>Air inlet:</b>	8.0 °C	<b>Pressure drop:</b>	0.71 bar
<b>Air outlet:</b>	4.0 °C	<b>Volume flow:</b>	1.83 m <sup>3</sup> /h
<b>Air pressure:</b>	1013 mbar		

<b>Fans:</b>	1 Piece(s) 1~230V 50Hz	<b>Noise pressure level:</b>	56 dB(A) in 3.0 m <sup>(3)</sup>
<b>Data per motor (nominal data):</b>		<b>Noise power level:</b>	78 dB(A)
<b>Speed:</b>	1360 min-1	<b>Air throw:</b>	approx. 37 m <sup>(4)</sup>
<b>Capacity (mech./el.):</b>	0.30 kW/0.47 kW	<b>Frost:</b>	0.0 mm
<b>Current:</b>	2.20 A <sup>(5)</sup>		
<b>ErP:</b>	Compliant <sup>(6)</sup>		

<b>Casing:</b>	AlMg, Powder coated RAL 9003	<b>Tubes:</b>	Copper <sup>(7)</sup>
<b>Surface:</b>	30.8 m <sup>2</sup>	<b>Fins:</b>	Aluminum <sup>(7)</sup>
<b>Tube volume:</b>	11.4 l	<b>Connections per unit:</b>	
<b>Fin spacing:</b>	7.00 mm	<b>Inlet:</b>	28.0 * 1.50 mm
<b>Dry weight:</b>	65 kg <sup>(8)</sup>	<b>Outlet:</b>	28.0 * 1.50 mm
<b>Max. operating pressure:</b>	16.0 bar	<b>PED classification:</b>	Art. 3, par. 3 <sup>(9)</sup>

**Dimensions:**

- L = 1360 mm
- B = 660 mm
- H = 650 mm
- E = 890 mm
- F = 545 mm
- C = 240 mm
- A = 500 mm
- ØD = 11 mm
- K = G1¼

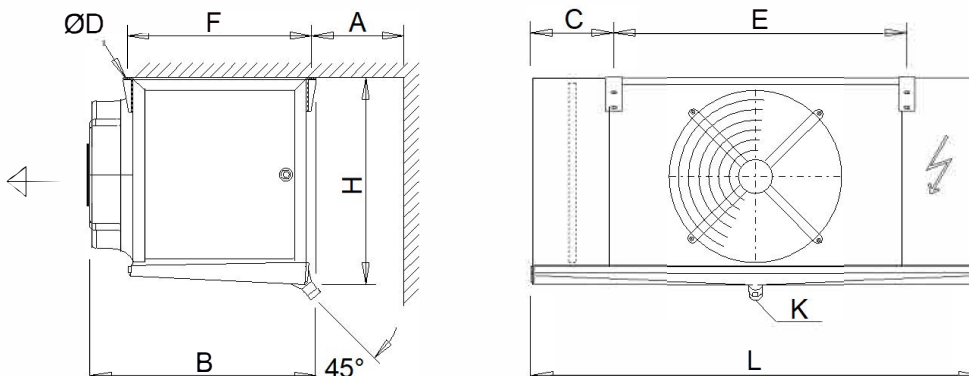

Drain according to DIN ISO 228-1 with G-thread (flat gasket).  
 Attention: Drawing and dimensions not valid for all accessory options!